

Overton Park NA

Bellaire Drive Median 76109
Beautification



7/25/2019 Rev -

Overton Park NA Proposes Bellaire Drive Adoption and Beautification

A History of Stewardship and Purveying

The Overton Park Neighborhood Association (OPNA) was founded in 2007, during the days of urban Gas lease negotiations, like many neighborhoods during that time.

The OPNA has active adoptions along two neighborhood roadway thoroughfares:

- [a] Seven Medians along Hulen Street, from Briarhaven Road to Ranch View Road, with irrigated plantings.
- [b] Three Medians along Arborlawn Drive, from Briarhaven Road to Hulen Street with xeriscape plantings.

Today the Hulen Street median has matured along one of Fort Worth's most traveled major arterial roadways and features Red, Burr and Live Oak Trees, Crepe Myrtles, Red Yucca, other Xeriscape plantings, as well as Overton Park's iconic split rail fencing.

Bellaire Drive Median

A key element of the newly proposed Bellaire Drive Median Beautification is the use of native plants that fit a xeriscape concept — meaning low maintenance and zero [or] low water needs for this new project.

The design elements are Red Yucca and Smooth Cactus flower beds, highlighted with Purple Crepe Myrtles (**TCU**).

The OPNA will provide all landscape materials and installation like we did for the Hulen & Arborlawn Medians.



Guidelines for Landscaping in Parkway

Public Open Space Easement (P.O.S.E.)

A 20 foot by 20 foot triangular public open space easement is required on corner lots at the intersection of two streets. A 15 foot by 15 foot triangular public open space of easement is required on corner lots at the intersection of an alley and a street. In addition, at the intersection of a driveway or turnout section and a dedicated alley, a 10 foot by 10 foot triangular open space easement is to be provided on each side at the driveway or turnout at the time the driveway and/or alley is constructed.

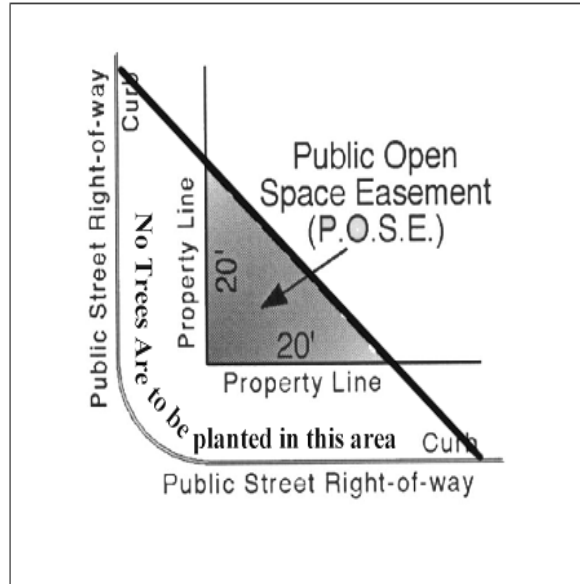

No structure, object, or plant of any type may obstruct vision from a height of 24-inches to a height of 11 feet above the top of the curb, including, but not limited to buildings, fences, walks, signs, trees, shrubs, cars, trucks, ect., in the public open space easement as shown on the above illustration.

Landscaping in Parkway

- A tree shall be planted a minimum of 2 feet from the face of the curb, sidewalk or other structure.
- In residential areas a minimum spacing of twenty-five feet is recommended between shade trees planted on parkways and is required in commercial districts or major arterial streets.

- Minimum planting area of 3 feet must be available between back of curb and sidewalk to plant any small tree or large shrub and a minimum of 4 feet to plant large trees. A large tree shall be defined as a species that reach a height of 50 feet at maturity.
- All landscaping shall be located so that pedestrians can walk parallel to the street within the parkway whether a paved sidewalk is or is not provided.
- No tree or shrub shall obstruct the view of any traffic signal, sign, or other public sign.
- Any tree or shrub planted in the parkway is the property of the city and the city reserves the right to prune or remove such tree or shrub if it become a traffic hazard or poses risk.
- Planting trees or shrubs on any public property requires a permit from Parks and Community Services and can be obtained by calling the City Forester at 817 871 5705.

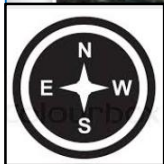
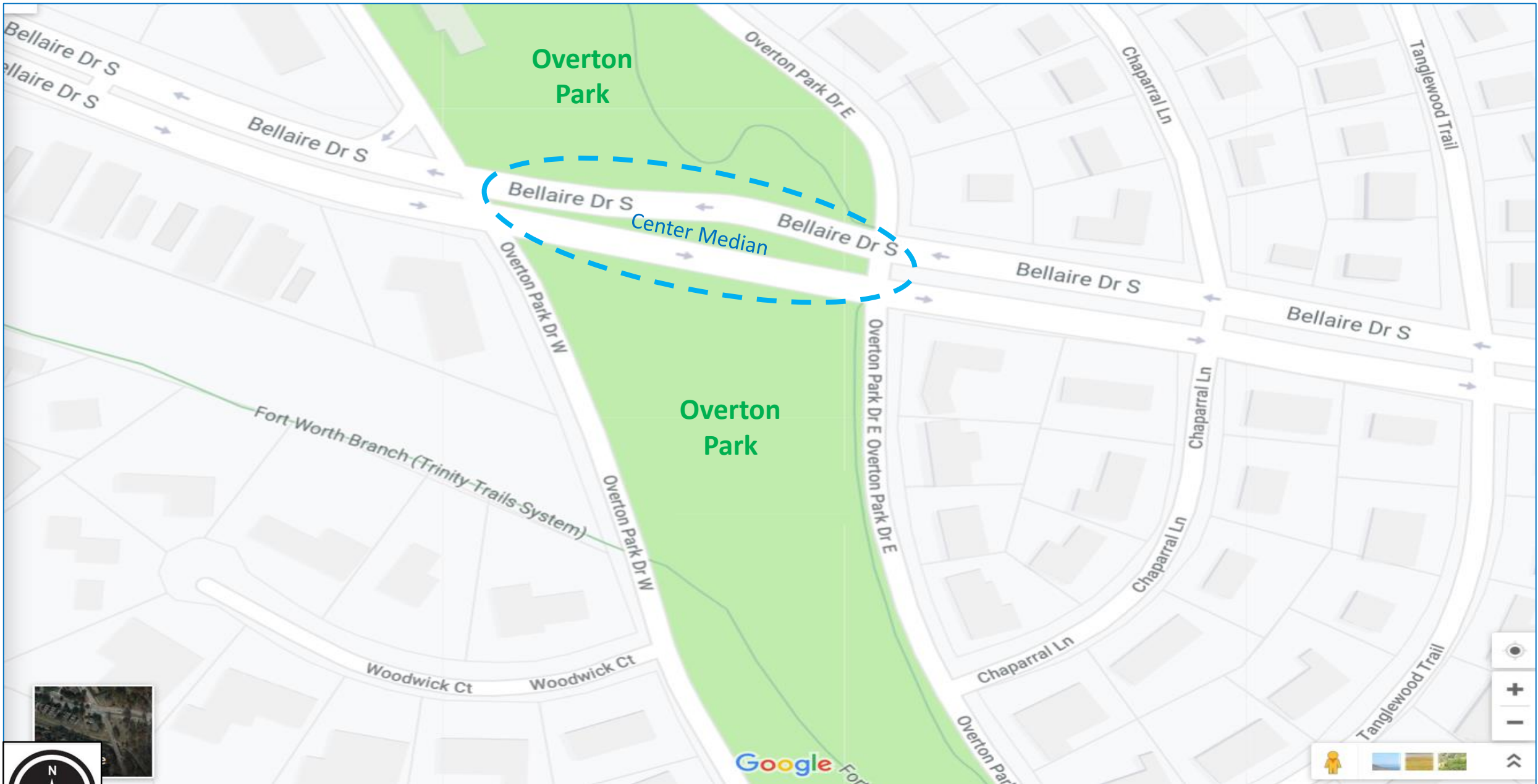

Overton Park NA Bellaire Drive Median Beautification

www.overtonpark-na.org

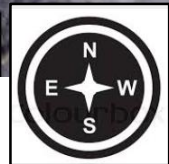

Overton Park NA Bellaire Drive Median Beautification

www.overtonpark-na.org

Bellaire Dr S

Fort Worth, Texas



Google



Street View - Feb 2019



Google



Overton Park NA Bellaire Drive Median Beautification

www.overtonpark-na.org

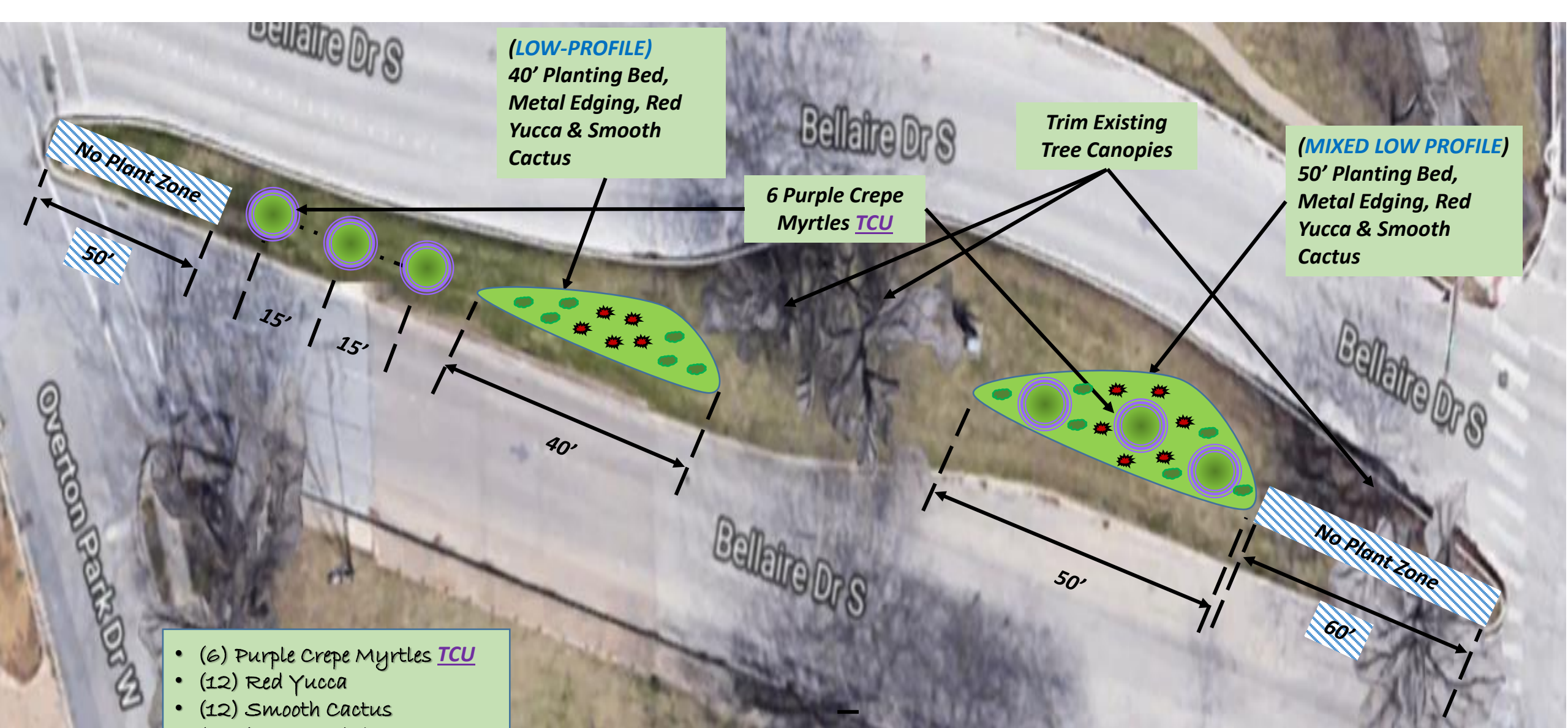

(LOW-PROFILE)
40' Planting Bed,
Metal Edging, Red
Yucca & Smooth
Cactus

6 Purple Crepe
Myrtles TCU

Trim Existing
Tree Canopies

(MIXED LOW PROFILE)
50' Planting Bed,
Metal Edging, Red
Yucca & Smooth
Cactus

- (6) Purple Crepe Myrtles TCU
- (12) Red Yucca
- (12) Smooth Cactus
- (180') Metal Edging
- (18 Bags) of Mulch



LOW PROFILE PLANTING BED

- Red Yucca
- Smooth Cactus

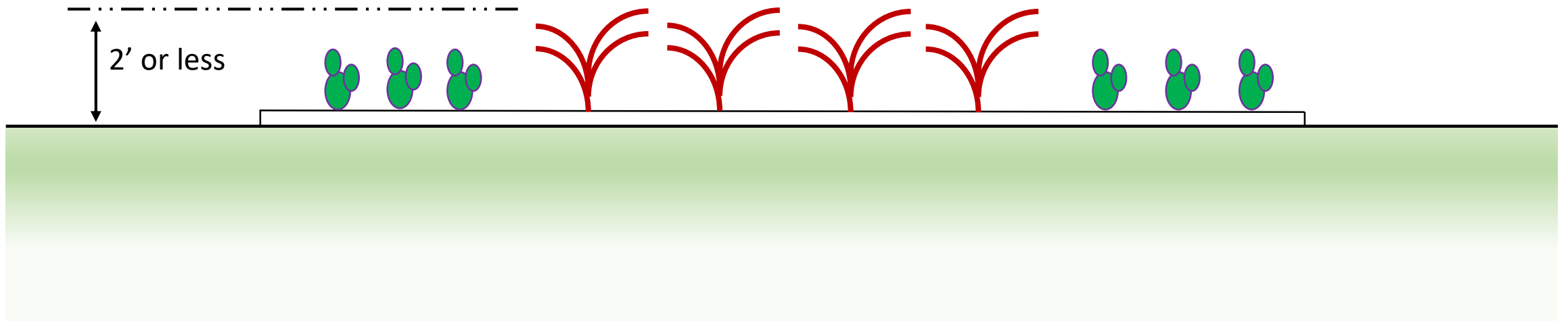

MIXED PLANTING BED

- Purple Crepe Myrtles
- Smooth Cactus

